



UNITED NATION DEVELOPMENT PROGRAM
UNDP



ACTION AID AFGHANISTAN
AAA

Afghanistan Community Resilience Programme
ACRP Extension





CONSTRUCTION OF Market Shed (Community Level)



DRAWING

BADGHIS PROVINCE, WEST REGION, AFGHANISTAN

QADIS AND BALA MURGHAB DISTRICTS (LANGAR SHARIF BAZAAR)

Date: April-2026

Legend Table	
Symbol	Description
	Proposed Market Shed Location at community level
	Restaurant
	Shops
	Healthcare Clinic

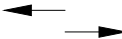
Legend Table	
Symbol	Description
	Houses
	Tree
	Main Road

Site Plan of Market Shed



Note:

All dimensions are in centimeter, otherwise specified.

Technical Specifications:

- Concrete mix shall be proportioned by volume with a water / cement ratio of not more than 0.45.
- Water should be drinking water for mixing and curing.
- PCC 15Mpa ratio mix (M1:2:4)(Cement, Sand and Crush).
- RCC 20Mpa ratio mix (M1:1.5:3)(Cement, Sand and Crush).
- Aggregate should be free of soil and other organic material.
- Water should be drinking water for mixing and curing.
- Site engineer is authorized to adjust the angles, location, and over all keeps the structure in its best position as per real condition of the site.



act:onaid

PROJECT:
AFGHANISTAN COMMUNITY RESILIENCE PROGRAM (ACRP), WEST REGION.

SUB-PROJECT:
CONSTRUCTION OF MARKET SHED (COMMUNITY LEVEL) IN QADIS AND BALA MURGHAB DISTRICTS, BADGHIS PROVINCE

DRAWING:
Site PLAN MARKET SHED IN LANGAR SHARIF BAZAAR

PROJECT SYMBOL: ACRP / AFG / WEST
SUB-PROJECT CODE NO:
DRAWING PAGE NO: 1
REVISION NO: (1)

Action Taken	Name	Designation
Surveyed By:	AAA Survey Team	AAA Survey Team
Designed By:	AAA Design Team	AAA Design Team
Drawn By:	AAA Design Team	AAA Design Team
Reviewed By:	AAA NGR T.J. Team	AAA NGR T.J. Team
Checked By:	AAA Technical Team	AAA Technical Team
Approved By:		

Drawing Scale: As Shown Date: April 2026

Plan of Market Shed

Scale 1:50

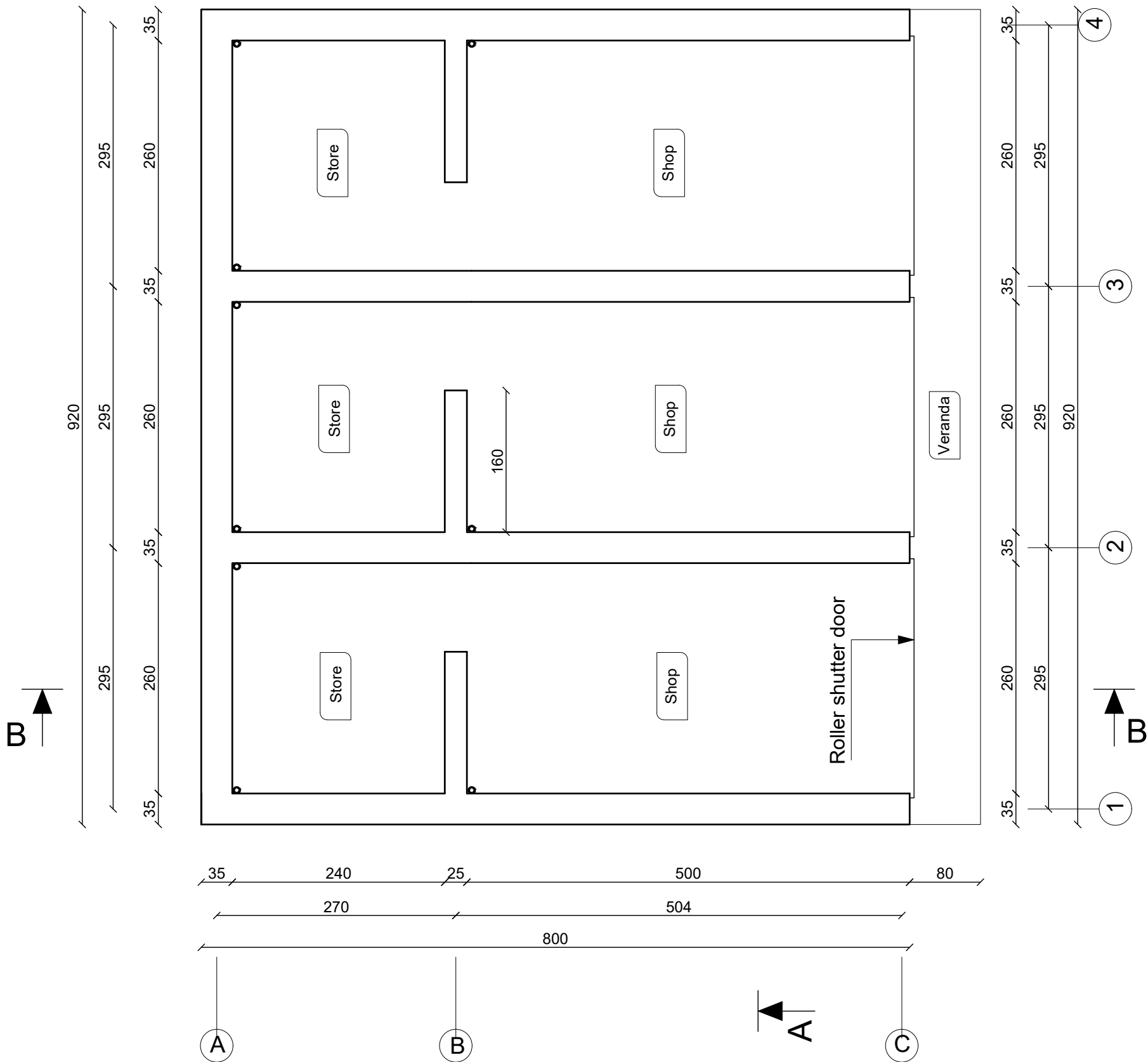

- Note:**
- All dimensions are in centimeter, otherwise specified.
- Technical Specifications:**
- Concrete mix shall be proportioned by volume with a water / cement ratio of not more than 0.45.
 - Water should be drinking water for mixing and curing.
 - PCC 15Mpa ratio mix (M1:2:4) (Cement, Sand and Crush).
 - RCC 20Mpa ratio mix (M1:1.5:3) (Cement, Sand and Crush).
 - Aggregate should be free of soil and other organic material.
 - Water should be drinking water for mixing and curing.
 - Site engineer is authorized to adjust the angles, location, and over all keeps the structure in its best position as per real condition of the site.



PROJECT: AFGHANISTAN COMMUNITY RESILIENCE PROGRAM (ACRP), WEST REGION.		
SUB-PROJECT: CONSTRUCTION OF MARKET SHED (COMMUNITY LEVEL) IN QADIS AND BALA MURGHAB DISTRICTS, BADGHIS PROVINCE		
DRAWING: PLAN VIEW MARKET SHED IN LANGAR SHARIF BAZAAR		
PROJECT SYMBOL: ACRP / AFG / WEST		
SUB-PROJECT CODE NO:		
DRAWING PAGE NO: 2		
REVISION NO: (1)		
Action Taken	Name	Designation
Surveyed By:	AAA Survey Team	AAA Survey Team
Designed By:	AAA Design Team	AAA Design Team
Drawn By:	AAA Design Team	AAA Design Team
Reviewed By:	AAA NGR T..I Team	AAA NGR T..I Team
Checked By:	AAA Technical Team	AAA Technical Team
Approved By:		
Drawing Scale: As Shown		Date: April 2026

Foundation (Stone Masonry) Plan

Scale 1:50

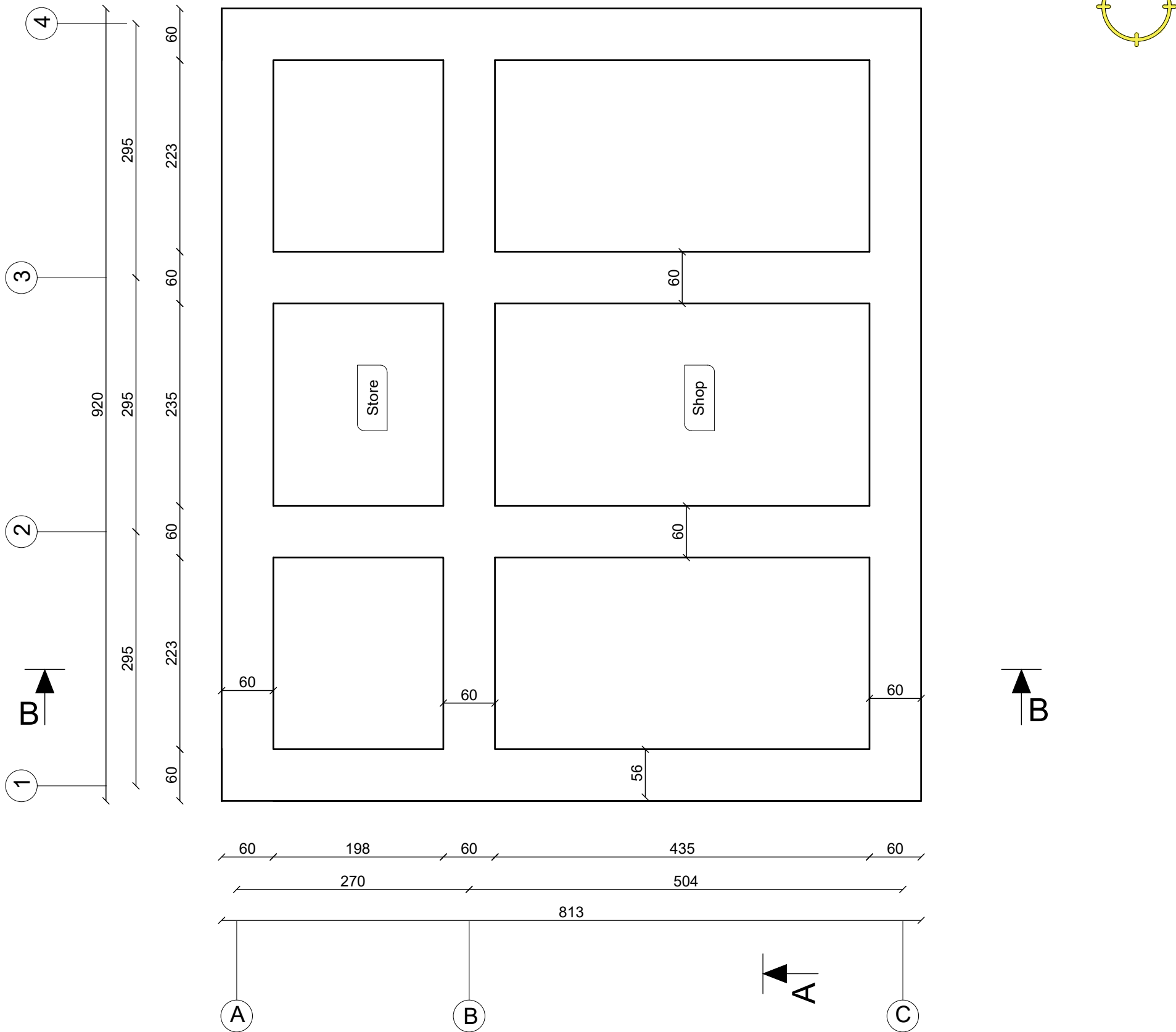

Note:

All dimensions are in centimeter, otherwise specified.

Technical Specifications:

- Concrete mix shall be proportioned by volume with a water / cement ratio of not more than 0.45.
- Water should be drinking water for mixing and curing.
- PCC 15Mpa ratio mix (M1:2:4)/(Cement, Sand and Crush).
- RCC 20Mpa ratio mix (M1:1.5:3)/(Cement, Sand and Crush).
- Aggregate should be free of soil and other organic material.
- Water should be drinking water for mixing and curing.
- Site engineer is authorized to adjust the angles, location, and over all keeps the structure in its best position as per real condition of the site.

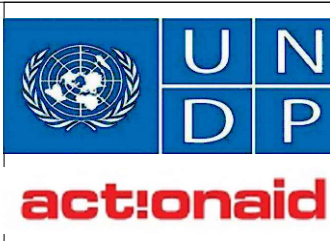

PROJECT:
AFGHANISTAN COMMUNITY RESILIENCE PROGRAM (ACRP), WEST REGION.

SUB-PROJECT:
CONSTRUCTION OF MARKET SHED (COMMUNITY LEVEL) IN QADIS AND BALA MURGHAB DISTRICTS, BADGHIS PROVINCE

DRAWING:
STONE MASONRY PLAN OF MARKET SHED IN LANGAR SHARIF BAZAAR

PROJECT SYMBOL: ACRP / AFG / WEST
SUB-PROJECT CODE NO:
DRAWING PAGE NO: 3
REVISION NO: 1

Action Taken	Name	Designation
Surveyed By:	AAA Survey Team	AAA Survey Team
Designed By:	AAA Design Team	AAA Design Team
Drawn By:	AAA Design Team	AAA Design Team
Reviewed By:	AAA NGR T..I Team	AAA NGR T..I Team
Checked By:	AAA Technical Team	AAA Technical Team
Approved By:		

Drawing Scale: As Shown Date: April 2026

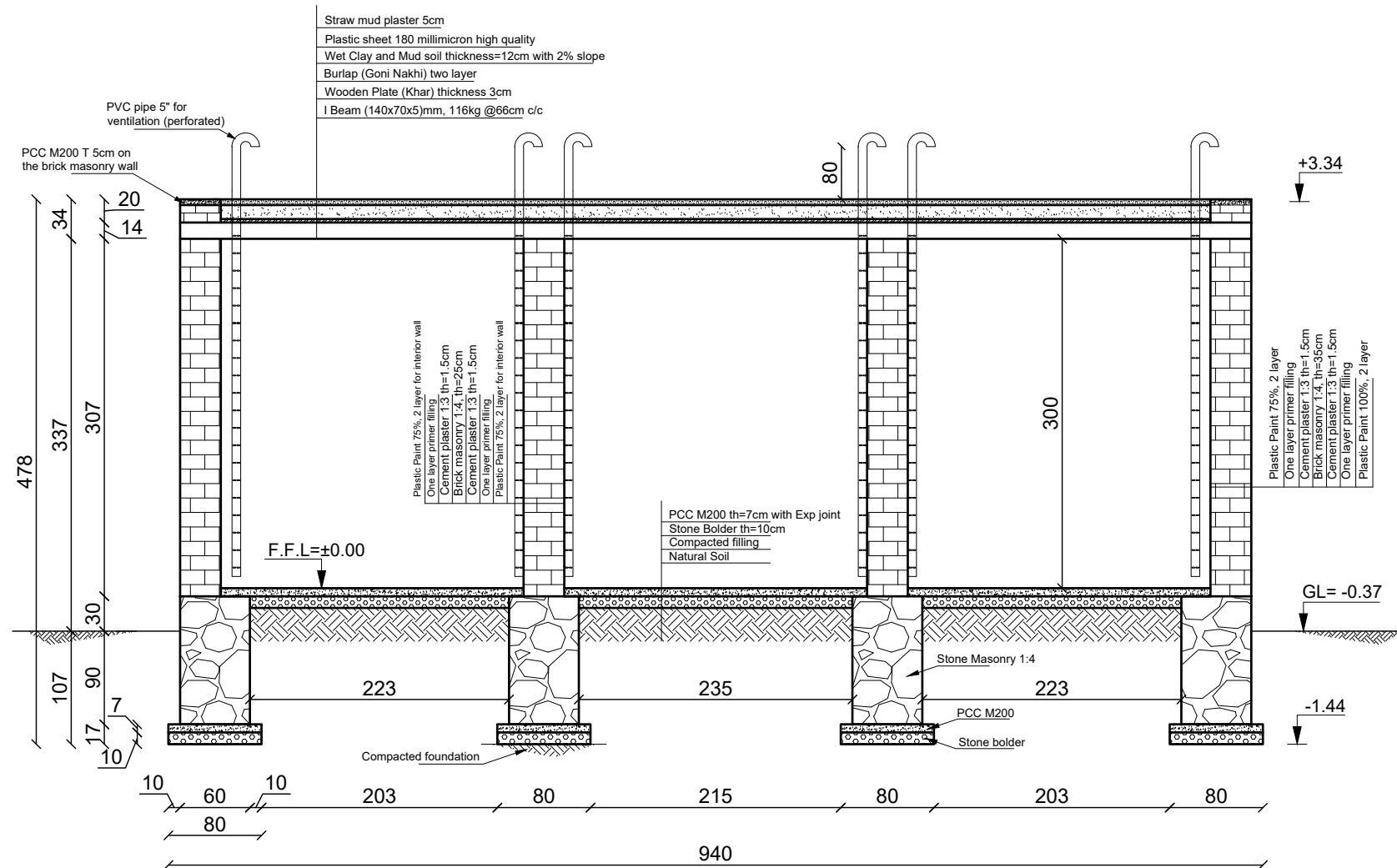

Section A-A
Scale 1:50

Note: Expansion joints in PCC of floors should be considered in 1.5-2m length, filled with wood or glass.

Note:

All dimensions are in centimeter, otherwise specified.

Technical Specifications:

1. Concrete mix shall be proportioned by volume with a water / cement ratio of not more than 0.45.
2. Water should be drinking water for mixing and curing.
3. PCC 15Mpa ratio mix (M1:2:4) (Cement, Sand and Crush).
4. RCC 20Mpa ratio mix (M1:1.5:3) (Cement, Sand and Crush).
5. Aggregate should be free of soil and other organic material.
6. Water should be drinking water for mixing and curing.
7. Site engineer is authorized to adjust the angles, location, and over all keeps the structure in its best position as per real condition of the site.



act:onaid

PROJECT:
AFGHANISTAN COMMUNITY RESILIENCE
PROGRAM (ACRP), WEST REGION.

SUB-PROJECT:
CONSTRUCTION OF MARKET SHED
(COMMUNITY LEVEL) IN QADIS AND BALA
MURGHAB DISTRICTS, BADGHIS PROVINCE

DRAWING:
SECTION OF MARKET SHED IN LANGAR
SHARIF BAZAAR

PROJECT SYMBOL: ACRP / AFG / WEST

SUB-PROJECT CODE NO:

DRAWING PAGE NO: 4

REVISION NO: 1

Action Taken	Name	Designation
Surveyed By:	AAA Survey Team	AAA Survey Team
Designed By:	AAA Design Team	AAA Design Team
Drawn By:	AAA Design Team	AAA Design Team
Reviewed By:	AAA NGR T..I Team	AAA NGR T..I Team
Checked By:	AAA Technical Team	AAA Technical Team
Approved By:		

Drawing Scale: As Shown Date: April 2026

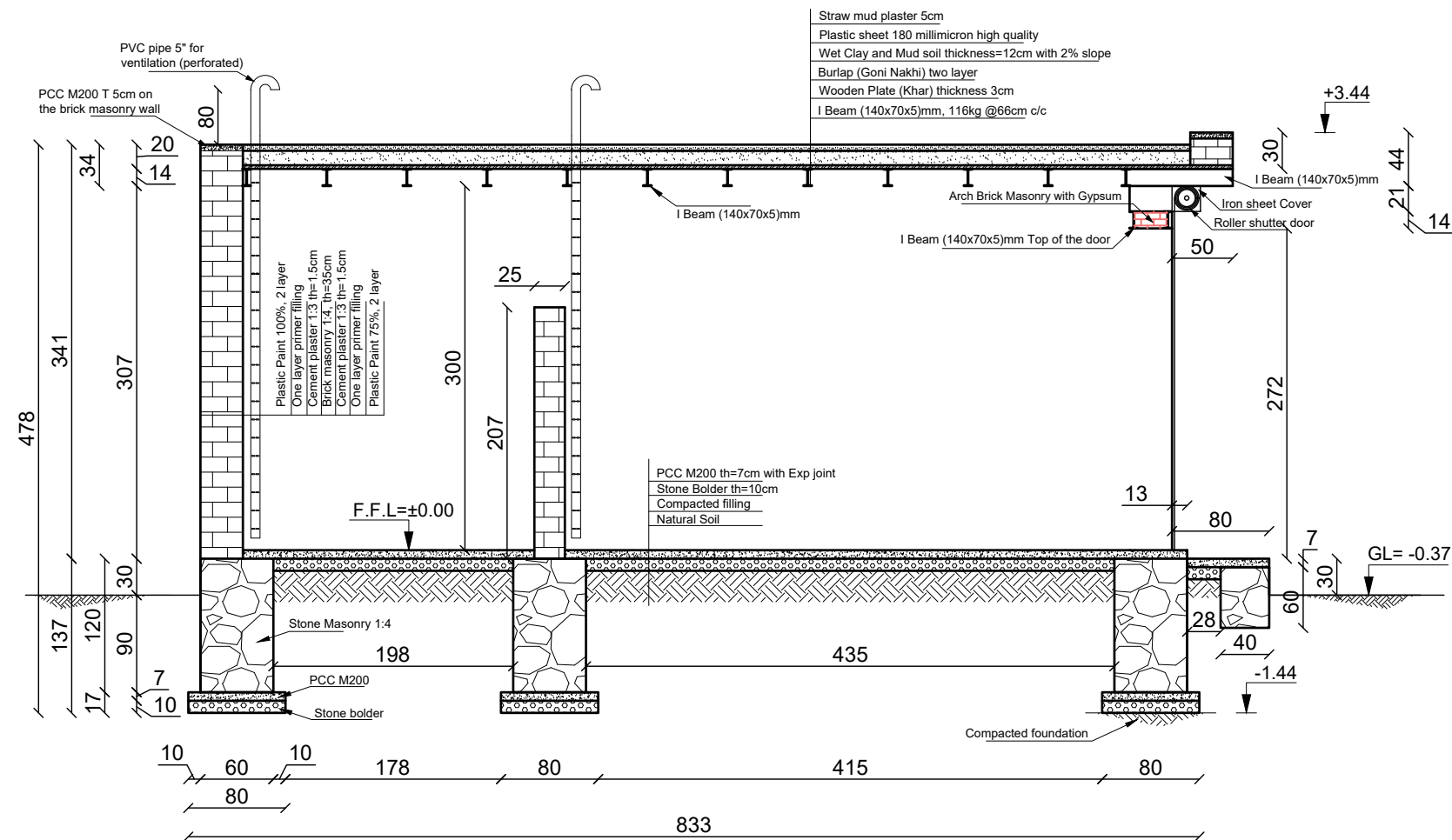

Section B-B

Scale 1:50

Note: Expansion joints in PCC of floors should be considered in 1.5-2m length, filled with wood or glass.

Roller Shutter Door

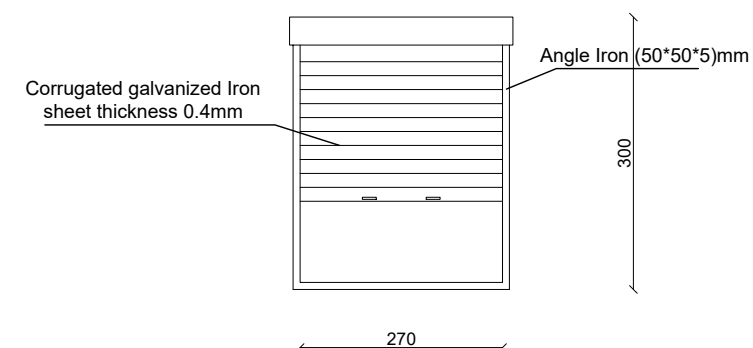

Note:

All dimensions are in centimeter, otherwise specified.

Technical Specifications:

- Concrete mix shall be proportioned by volume with a water / cement ratio of not more than 0.45.
- Water should be drinking water for mixing and curing.
- PCC 15Mpa ratio mix (M1:2:4) (Cement, Sand and Crush).
- RCC 20Mpa ratio mix (M1:1.5:3) (Cement, Sand and Crush).
- Aggregate should be free of soil and other organic material.
- Water should be drinking water for mixing and curing.
- Site engineer is authorized to adjust the angles, location, and over all keeps the structure in its best position as per real condition of the site.



actionaid

PROJECT:
AFGHANISTAN COMMUNITY RESILIENCE
PROGRAM (ACRP), WEST REGION.

SUB-PROJECT:
CONSTRUCTION OF MARKET SHED
(COMMUNITY LEVEL) IN QADIS AND BALA
MURGHAB DISTRICTS, BADGHIS PROVINCE

DRAWING:
SECTION OF MARKET SHED IN LANGAR
SHARIF BAZAAR

PROJECT SYMBOL: ACRP / AFG / WEST

SUB-PROJECT CODE NO:

DRAWING PAGE NO: 5

REVISION NO: (1)

Action Taken	Name	Designation
Surveyed By:	AAA Survey Team	AAA Survey Team
Designed By:	AAA Design Team	AAA Design Team
Drawn By:	AAA Design Team	AAA Design Team
Reviewed By:	AAA NGR T.J Team	AAA NGR T.J Team
Checked By:	AAA Technical Team	AAA Technical Team
Approved By:		

Drawing Scale: As Shown

Date: April 2026

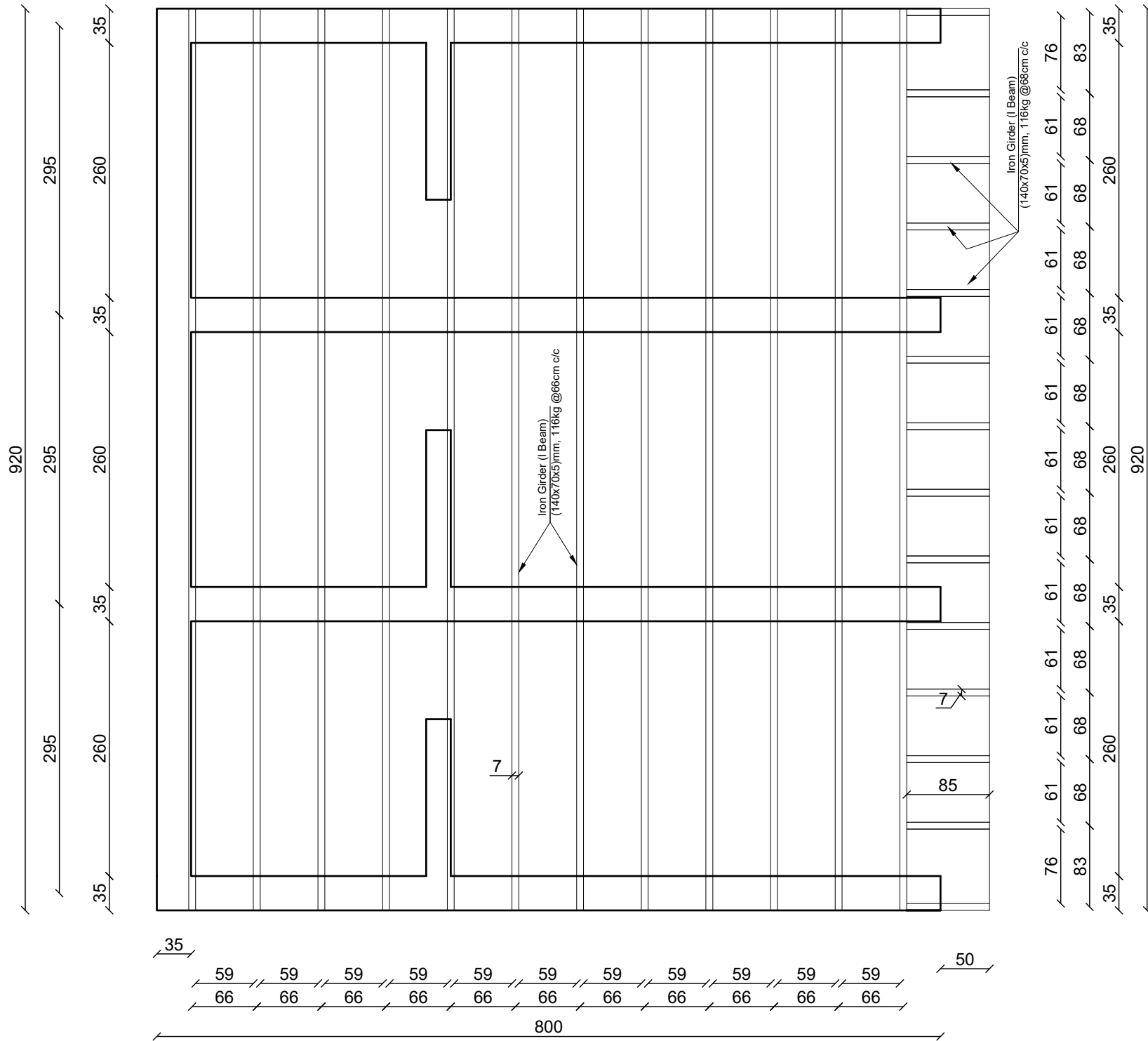

Iron Girder Plan

Scale 1:50

Note:

- The iron girders shall be securely fastened and welded together by using steel rebars of 16 mm diameter (or steel tape width 5cm and thickness 5 mm) at the first, middle and end.
- Angle Iron 50x50x5 mm shall be installed at the terminal ends of the console or veranda girders to ensure structural stability and proper finishing.

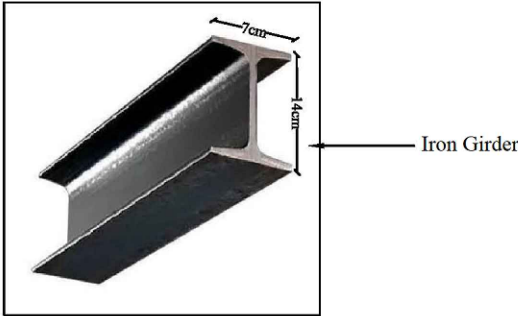

Note:

All dimensions are in centimeter, otherwise specified.

Technical Specifications:

- Concrete mix shall be proportioned by volume with a water / cement ratio of not more than 0.45.
- Water should be drinking water for mixing and curing.
- PCC 15Mpa ratio mix (M1:2:4) (Cement, Sand and Crush).
- RCC 20Mpa ratio mix (M1:1.5:3) (Cement, Sand and Crush).
- Aggregate should be free of soil and other organic material.
- Water should be drinking water for mixing and curing.
- Site engineer is authorized to adjust the angles, location, and over all keeps the structure in its best position as per real condition of the site.



PROJECT: AFGHANISTAN COMMUNITY RESILIENCE PROGRAM (ACRP), WEST REGION.		
SUB-PROJECT: CONSTRUCTION OF MARKET SHED (COMMUNITY LEVEL) IN QADIS AND BALA MURGHAB DISTRICTS, BADGHIS PROVINCE		
DRAWING: IRON GIRDER PLAN AND DETAILS OF MARKET SHED IN LANGAR SHARIF BAZAAR		
PROJECT SYMBOL: ACRP / AFG / WEST		
SUB-PROJECT CODE NO:		
DRAWING PAGE NO: 6		
REVISION NO: 1		
Action Taken	Name	Designation
Surveyed By:	AAA Survey Team	AAA Survey Team
Designed By:	AAA Design Team	AAA Design Team
Drawn By:	AAA Design Team	AAA Design Team
Reviewed By:	AAA NGR T..I Team	AAA NGR T..I Team
Checked By:	AAA Technical Team	AAA Technical Team
Approved By:		
Drawing Scale: As Shown		Date: April 2026

Roof Rain Water Plan

Scale 1:50

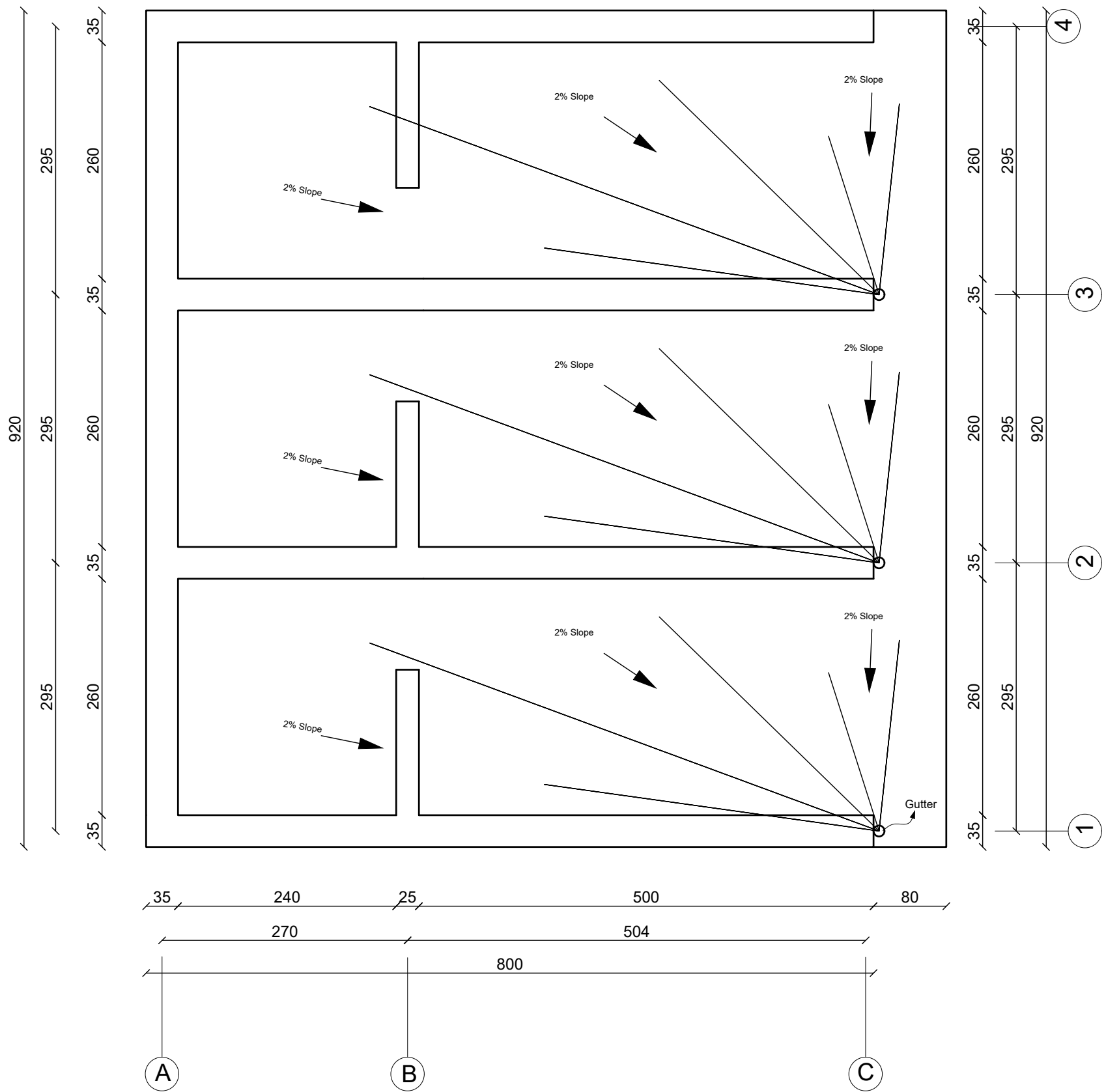

Note:

All dimensions are in centimeter, otherwise specified.

Technical Specifications:

1. Concrete mix shall be proportioned by volume with a water / cement ratio of not more than 0.45.
2. Water should be drinking water for mixing and curing.
3. PCC 15Mpa ratio mix (M1:2:4) (Cement, Sand and Crush).
4. RCC 20Mpa ratio mix (M1:1.5:3) (Cement, Sand and Crush).
5. Aggregate should be free of soil and other organic material.
6. Water should be drinking water for mixing and curing.
7. Site engineer is authorized to adjust the angles, location, and over all keeps the structure in its best position as per real condition of the site.



PROJECT:
AFGHANISTAN COMMUNITY RESILIENCE
PROGRAM (ACRP), WEST REGION.

SUB-PROJECT:
CONSTRUCTION OF MARKET SHED
(COMMUNITY LEVEL) IN QADIS AND BALA
MURGHAB DISTRICTS, BADGHIS PROVINCE

DRAWING:
ROOF RAIN WATER PLAN OF MARKET
SHED IN LANGAR SHARIF BAZAAR

PROJECT SYMBOL: ACRP / AFG / WEST

SUB-PROJECT CODE NO:

DRAWING PAGE NO: 7

REVISION NO: 1

Action Taken	Name	Designation
Surveyed By:	AAA Survey Team	AAA Survey Team
Designed By:	AAA Design Team	AAA Design Team
Drawn By:	AAA Design Team	AAA Design Team
Reviewed By:	AAA NGR T.J Team	AAA NGR T.J Team
Checked By:	AAA Technical Team	AAA Technical Team
Approved By:		

Drawing Scale: As Shown

Date: April 2026

Electrical Equipment		
S/No	Symbol	Specification
1	⊗	Selling light 24 watt with circular cover including all equipment
2	⊕	two pol switch under plaster with cover box high quality
3	⚡	Socket under plaster with cover box high quality
4	□	Joint box under plaster high quality
5	—	Electrical wire 2.5mm inside the PVC pipe 1 inch for fan & lighting
4	—	Electrical wire 4mm inside the PVC pipe 1 inch for socket
4	⚙	Fan large size Irani, with all equipment, high quality
4	⚡	Main panel board size (50x80) cm with all equipments and work, high quality

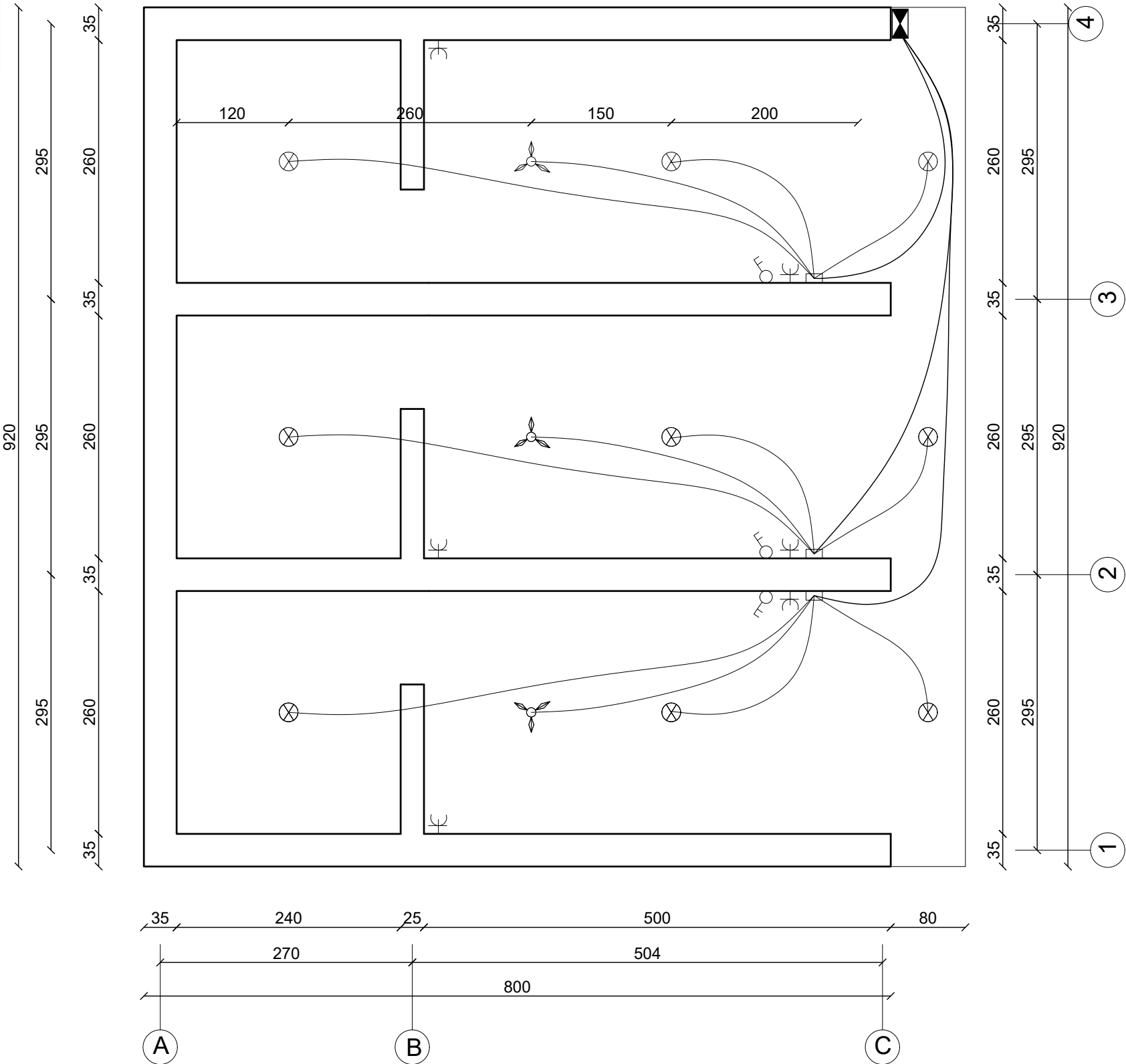

Electrical Plan
Scale 1:50

Note:

All dimensions are in centimeter, otherwise specified.

Technical Specifications:

- Concrete mix shall be proportioned by volume with a water / cement ratio of not more than 0.45.
- Water should be drinking water for mixing and curing.
- PCC 15Mpa ratio mix (M1:2:4) (Cement, Sand and Crush).
- RCC 20Mpa ratio mix (M1:1.5:3) (Cement, Sand and Crush).
- Aggregate should be free of soil and other organic material.
- Water should be drinking water for mixing and curing.
- Site engineer is authorized to adjust the angles, location, and over all keeps the structure in its best position as per real condition of the site.



PROJECT:
AFGHANISTAN COMMUNITY RESILIENCE
PROGRAM (ACRP), WEST REGION.

SUB-PROJECT:
CONSTRUCTION OF MARKET SHED
(COMMUNITY LEVEL) IN QADIS AND BALA
MURGHAB DISTRICTS, BADGHIS PROVINCE

DRAWING:
ELECTRICAL PLAN IN LANGAR SHARIF
BAZAAR

PROJECT SYMBOL: ACRP / AFG / WEST

SUB-PROJECT CODE NO:

DRAWING PAGE NO: 8

REVISION NO: 1

Action Taken	Name	Designation
Surveyed By:	AAA Survey Team	AAA Survey Team
Designed By:	AAA Design Team	AAA Design Team
Drawn By:	AAA Design Team	AAA Design Team
Reviewed By:	AAA NGR T..I Team	AAA NGR T..I Team
Checked By:	AAA Technical Team	AAA Technical Team
Approved By:		

Drawing Scale: As Shown Date: April 2026